

# LAI Product-Specific Administration Review

Nathaniel M. Rickles, PharmD, PhD, BCPP, FAPhA  
Professor of Pharmacy Practice & Associate Dean of Admissions and  
Student Affairs

Kristin Waters, PharmD, BC  
Assistant Professor of Pharmacy Practice

# Learning Objectives

- Review administration instructions for LAI antipsychotics and medications for substance use disorders
- Compare and contrast how the administration techniques are similar or different for the different LAI medications.
- Demonstrate the use sterile injection techniques and best practices in the administration of different LAI products

# Disclosure

- Dr. Rickles is a consultant of the Boehringer-Ingelheim. There are no conflicts of interest with any companies or their products being presented today.
- Sharon Spicer has no disclosures or conflicts of interest.
- Dr. Waters is a consultant with Johnson & JOhnson. She will discuss all drugs without bias. All financial interests with ineligible companies (as noted) have been mitigated.

# Refer to Package Inserts

- Please always refer to instructions in up-to-date package inserts prior to administering any LAI medication.

# LAIAs

<b>Generic Antipsychotic</b>	<b>Brand Name</b>
Aripiprazole monohydrate	Abilify Maintena, Abilify Asimtufii
Aripiprazole lauroxil	Aristada, Aristada Initio
Fluphenazine decanoate	Prolixin Decanoate
Haloperidol decanoate	Haldol Decanoate
Paliperidone palmitate	Invega Sustenna, Invega Trinza, Invega Hafyera
Risperidone	Risperdal Consta, Rykindo, Uzedy
Olanzapine pamoate	Zyprexa Relprevv

# LAI Opioid Antagonists

<b>Generic</b>	<b>Brand Name</b>
Buprenorphine	Sublocade, Brixadi
Naltrexone	Vivitrol

# Abilify Maintena

## Package Contents (single-dose syringe)

Always inspect package contents to ensure all necessary components are included

- One Abilify Maintena prefilled dual chamber syringe containing lyophilized powder and sterile water for injection
- One 23 gauge, 1 inch hypodermic safety needle
- One 22 gauge, 1.5 inch hypodermic safety needle
- One 21 gauge, 2 inch hypodermic safety needle

# Abilify Maintena

## Preparation (single-dose syringe)

1. Push the plunger rod slightly and rotate fully. At this point, the stopper should be at the indicator line.

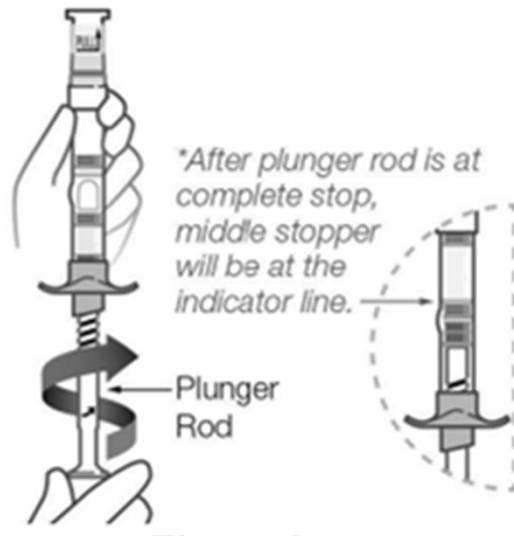

2. Shake the syringe, vertically and vigorously, until the drug appears uniform and milky-white.

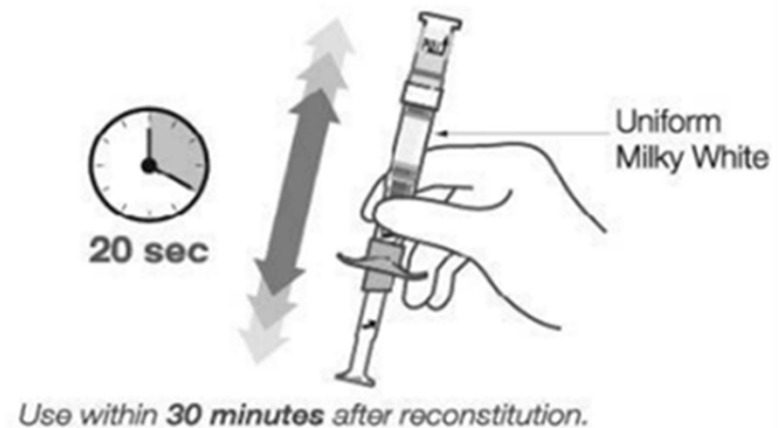



# Abilify Maintena

## Administration (single-dose syringe)

1. Select the proper needle size by injection site and patient body type

Injection Site	Body Type	Needle Size
Deltoid	Non-obese	23 gauge, 1 inch
	Obese	22 gauge, 1.5 inch
Gluteal	None-obese	22 gauge, 1.5 inch
	Obese	21 gauge, 2 inch

- Patients considered obese:  $BMI \geq 30 \text{ kg/m}^2$

# Abilify Maintena

## Administration (single-dose syringe)

1. Remove needle cap by pulling straight up and expel air from the syringe. Advance the plunger rod slowly until suspension fills needle base.



2. Slowly inject the appropriate muscle. When finished, engage the needle safety and appropriately dispose of all kit components.

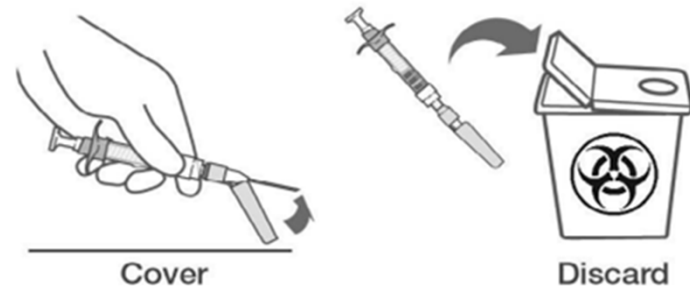

# Abilify Maintena

## Package Contents (vial)

- One vial of Abilify Maintena lyophilized powder
- One 5 mL vial of sterile water for injection
- One 3 mL luer lock syringe with pre-attached 21 gauge, 1.5 inch hypodermic safety needle
- One 3 mL luer lock disposable syringe
- One vial adapter
- One 23 gauge, 1 inch hypodermic safety needle
- One 22 gauge, 1.5 inch hypodermic safety needle
- One 21 gauge, 2 inch hypodermic safety needle

# Abilify Maintena

## Preparation (vial)

1. Determine the volume of sterile water needed to reconstitute the injection (Note: there will be some sterile water left over).
  - a. 300 mg vial = 1.5 mL sterile water for injection
  - b. 400 mg vial = 1.9 mL sterile water for injection
2. Remove the vial caps of both the sterile water for injection and Abilify Maintena lyophilized powder vials. Wipe both tops with a sterile alcohol swab.

# Abilify Maintena

## Preparation (vial)

3. Using the provided syringe with pre-attached needle, withdraw the necessary amount of sterile water for injection into the syringe.



4. Slowly inject the drawn sterile water into the vial containing the Abilify Maintena lyophilized powder.



# Abilify Maintena

## Preparation (vial)

5. Withdraw air from the vial to equalize pressure by pulling back slowly on the plunger. Remove the needle from the vial, engage needle safety, and properly discard.



6. Shake the reconstituted vial vigorously for 30 seconds, until the suspension is uniform.



# Abilify Maintena

## Preparation for Injection (vial)

1. Remove the cover from the vial adapter package. Do NOT remove the adapter from the packaging.



2. Attach the provided luer lock syringe to the vial adapter.



3. Remove the vial adapter from the package using the syringe. Do not touch the adapter spike tip.



# Abilify Maintena

## Preparation for Injection (vial)

4. Determine the volume of injection based on the designated dose

Dose	Volume to Inject
400 mg	2 mL
300 mg	1.5 mL
200 mg	1 mL
160 mg	0.8 mL

5. Wipe the top of the suspension with a sterile alcohol swab



# Abilify Maintena

## Preparation for Injection (vial)

6. With the vial placed on a hard surface, attach the adapter-syringe to the vial by pushing through the rubber stopper until the adapter snaps in place.



7. Slowly withdraw the predetermined volume for injection from the vial into the syringe. A small amount of excess leftover is expected.



# Abilify Maintena

## Administration (vial)

1. Detach the now filled luer lock syringe from the Abilify Maintena vial.
2. Select the appropriate needle size based on injection site and patient body type.
  - a. See needle size selections, slide 14.
3. Attach the needle by pushing and twisting clockwise until secure.
4. Slowly inject into the deltoid or gluteal muscle.
5. Engage needle safety and dispose of all components.

# Abilify Maintena

## Administration (vial)

If the Abilify Maintena vial is not administered immediately after reconstitution...

- Reconstituted vial may be kept below 25°C for up to 4 hours.
- Never store reconstituted suspension in a syringe.
  - Wait until time of administration to draw dose.
- Shake the vial vigorously for 60 seconds to resuspend before drawing dose.

# Abilify Asimtufii

## Package Contents

Always inspect package contents to ensure all necessary components have been included

- One Abilify Asimtufii prefilled syringe
- One 22 gauge, 1.5 inch hypodermic safety needle (black packaging)
- One 21 gauge, 2 inch hypodermic safety needle (green packaging)

# Abilify Asimtufii

## Preparation

1. Determine the appropriate needle size for your patient
  - a. For non-obese patients: 22 gauge, 1.5 inch
  - b. For obese patients: 21 gauge, 2 inch needle

2. Tap the syringe at least 10 times on the palm of a hand, then shake vigorously for at least 10 seconds (until uniform).

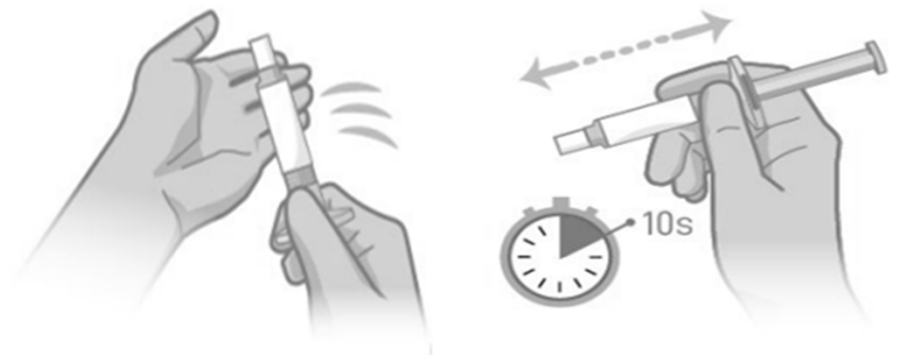

# Abilify Asimtufii

## Preparation

3. Twist and pull to remove the syringe tip cap. Attach preselected needle by pushing and twisting clockwise until secure.

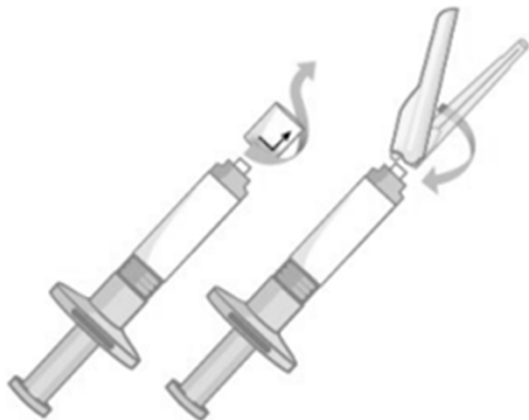

4. Holding the syringe upright, remove the needle cap and expel air by slowly advancing the plunger rod until suspension fills the needle base.

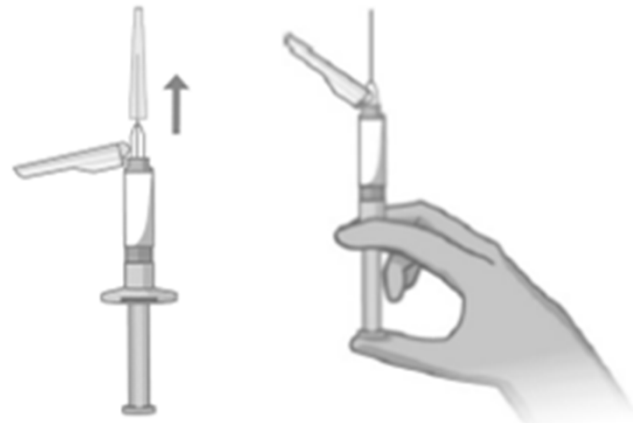

# Abilify Asimtufii

## Administration

Slowly inject the entire contents of the syringe intramuscularly into the gluteal muscle.

- The gluteal muscle is the **ONLY** administration site for Abilify Asimtufii

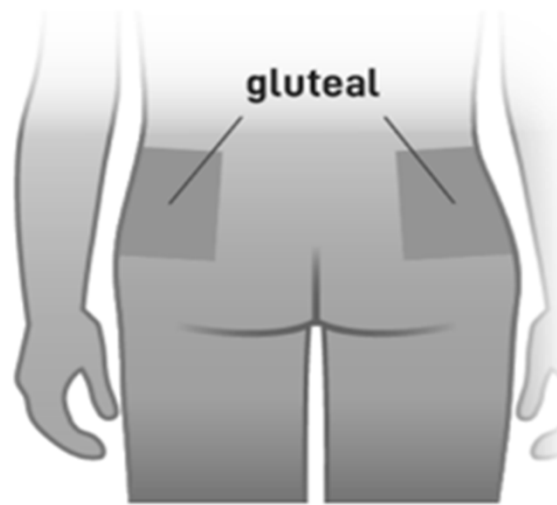

After administration, engage the needle's safety shield and discard appropriately.

# Aristada

## Package Contents

- One Aristada/Aristada Initio prefilled syringe
- 2-3 needles, depending on dosage pack
  - One 20 gauge, 2 inch safety needle
  - One 20 gauge, 1.5 inch needle
  - One 21 gauge, 1 inch needle



# Aristada

## Preparation

1. Select the appropriate needle size based on injection site and patient body type

<b>Injection Site</b>	<b>Needle Length</b>
441 mg dose and Aristada Initio (675 mg)	
Deltoid	21 gauge, 1 inch, or 20 gauge, 1.5 inch
Gluteal	20 gauge, 1.5 inch or 20 gauge, 2 inch
662, 882, and 1064 mg doses	
Gluteal only	20 gauge, 1.5 inch or 20 gauge, 2 inch

For patients with a larger amount of subcutaneous tissue, use the longer of the two needle options.

# Aristada

## Preparation

2. Tap the syringe against the palm of a hand at least 10 times. Then, shake vigorously for at least 30 seconds until the suspension is uniform.



# Aristada

## Preparation

3. Attach the appropriate injection needle securely with a clockwise twist.



4. Holding the syringe upright, tap out air bubbles. Expel additional air by slowly advancing the plunger rod until a few days are released.

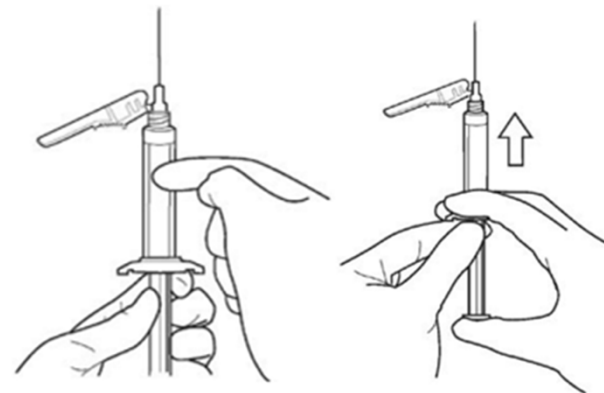

# Aristada

## Administration

1. Inject the entire contents of the syringe intramuscularly in a **RAPID** and **CONTINUOUS** manner. Do not hesitate.

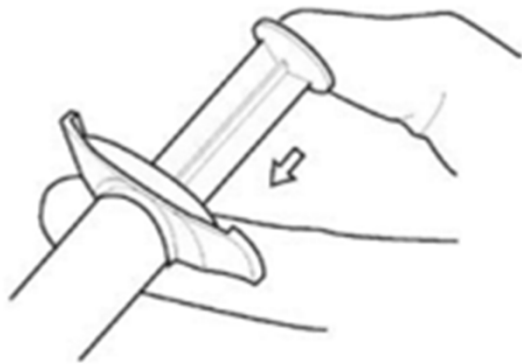

2. Engage the needle's safety by pressing it against a hard surface. Properly dispose of all used and unused components.



# Vivitrol

## Package Contents

- One vial of diluent
- One vial of Vivitrol microspheres for reconstitution
- One syringe
- One Terumo® 1 inch, 20 gauge preparation needle
- Two Terumo® 1.5 inch, 20 gauge needles with protection device
- Two Terumo® 2 inch, 20 gauge needles with protection device

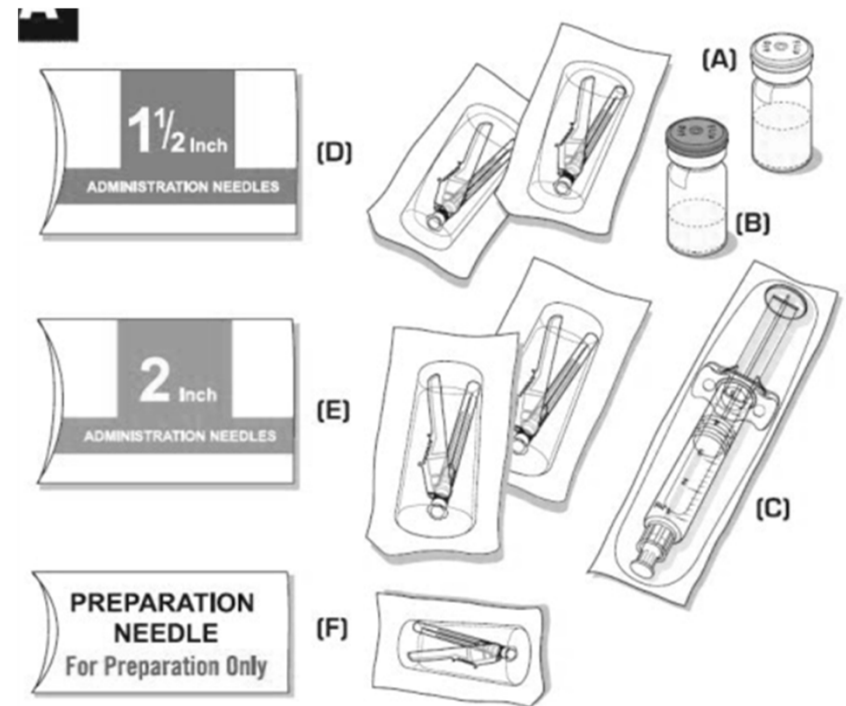

# Vivitrol

## Preparation

1. Remove Vivitrol from the refrigerator. Let sit until it has reached room temperature before reconstituting (about 45 minutes).
2. Firmly tap the Vivitrol vial on a hard surface to dislodge any packed powder.
3. Remove caps from both vials and wipe the stoppers with an alcohol swab.
4. Place the 1 inch preparation needle onto the syringe, and withdraw 3.4 mL of diluent from its vial. Some diluent will remain.

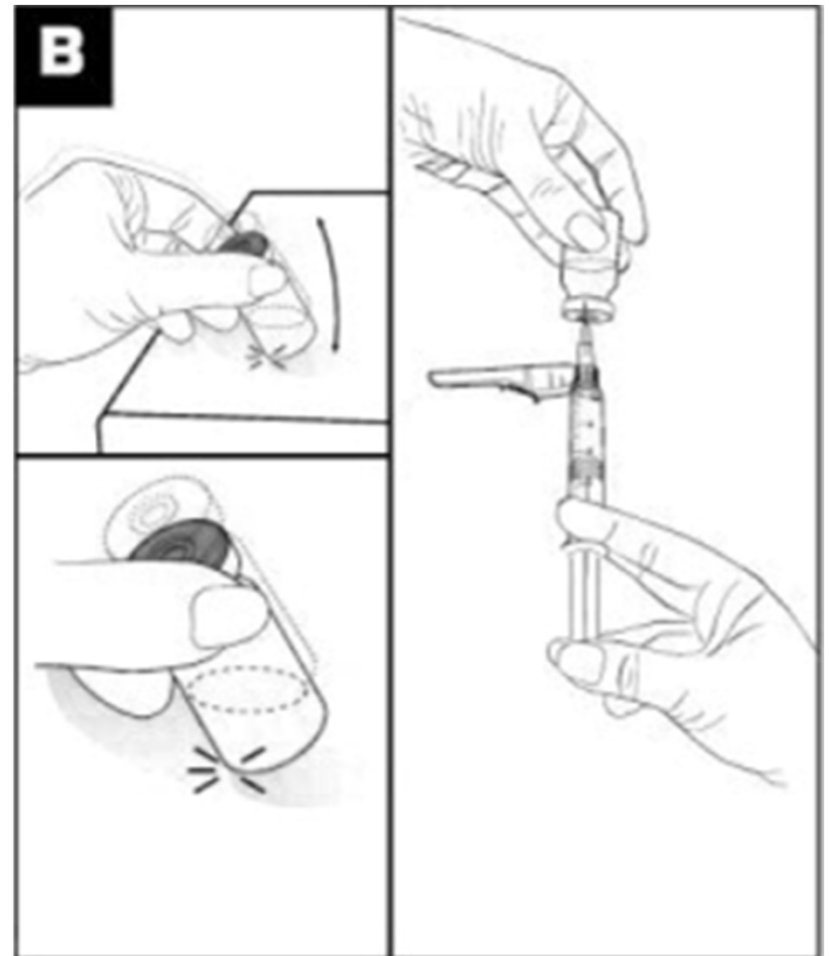

# Vivitrol

## Preparation

5. Inject the drawn 3.4 mL of diluent into the vial of Vivitrol microspheres.

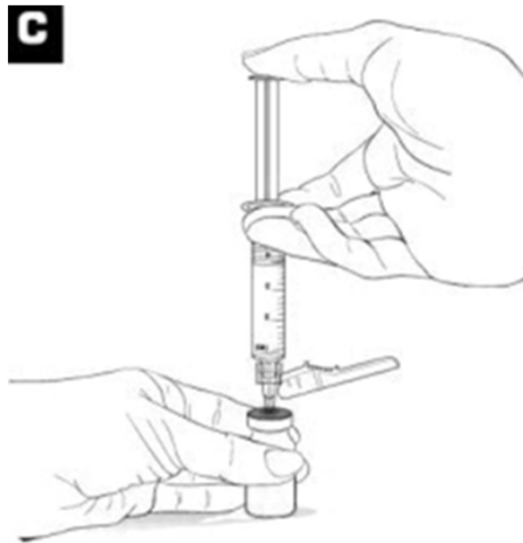

6. Mix the vial until suspended by vigorously shaking for approximately one minute.



# Vivitrol

## Preparation

7. Immediately after suspension, withdraw 4.2 mL into the syringe using the same preparation needle.

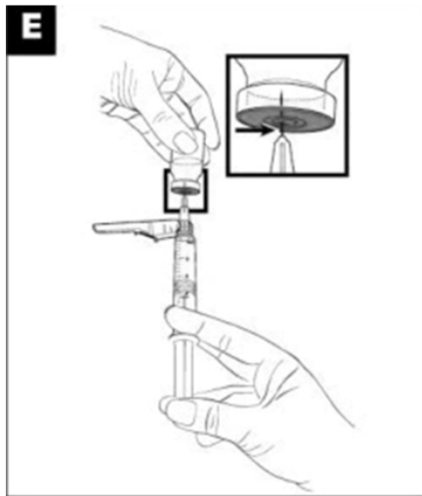

8. Select the appropriate needle size and secure to the syringe with a clockwise twist.

- For leaner patients, 1.5 inch needle.
- For patients with more subcutaneous tissue, 2 inch needle.

9. Remove the needle sheath. Release air bubbles by tapping the syringe and advance the plunger until 4 mL of suspension remains in the syringe.

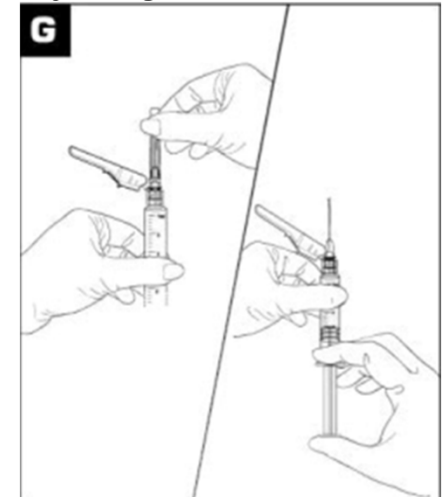

10. Suspension is now ready for administration.



# Vivitrol

## Administration

Vivitrol is administered by intramuscular injection into the gluteal muscle ONLY.

1. Insert the needle into the gluteal muscle and aspirate for blood.
  - a. If blood aspirates or the needle clogs, change to the spare needle provided and administer into an adjacent site in the same gluteal region.
2. Inject entire contents of the syringe in a smooth, continuous motion.
3. Engage needle safety by pressing on a hard surface and discard.

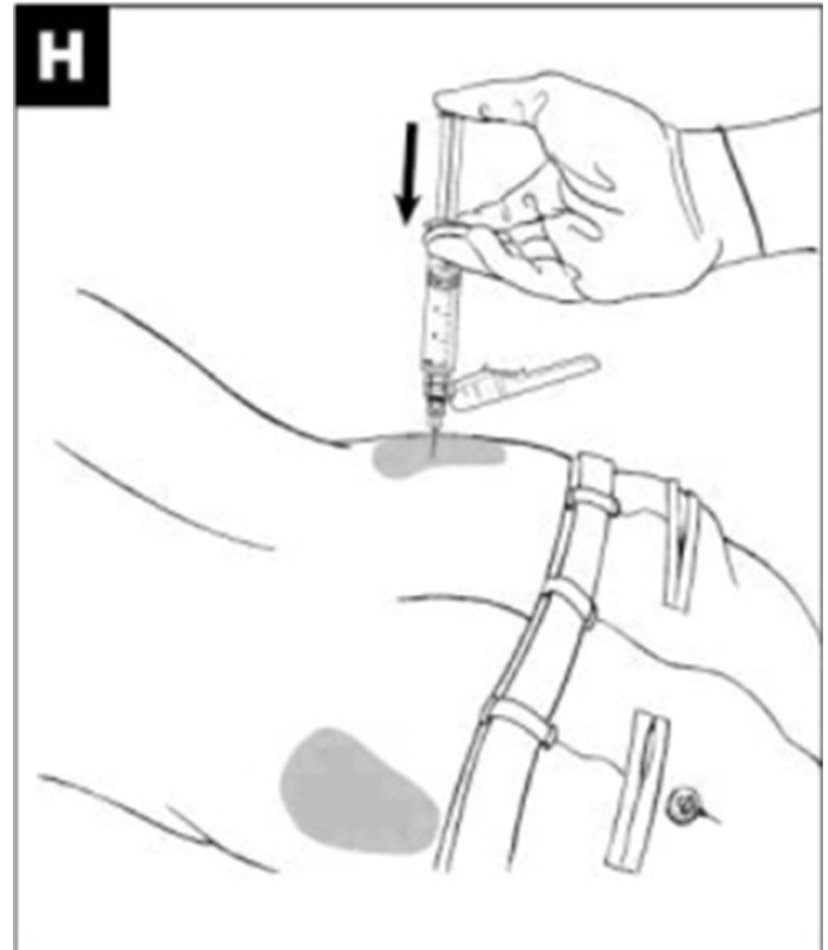

# Invega Sustenna

## Package Contents

- One Invega Sustenna prefilled syringe
- One 22 gauge, 1.5 inch safety needle (gray hub)
- One 23 gauge, 1 inch safety needle (blue hub)

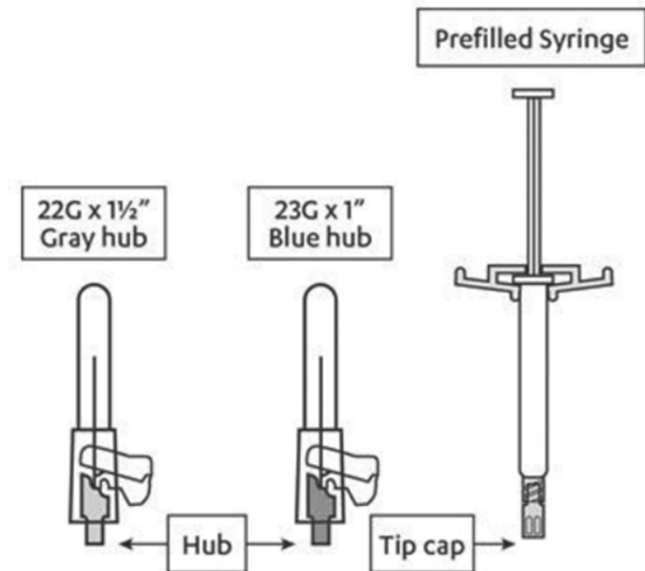

# Invega Sustenna

## Preparation

1. Select the appropriate needle size by injection site and patient weight

<b>Injection Site</b>	<b>Patient Weight</b>	<b>Needle Size</b>
Deltoid	< 90 kg	23 gauge, 1 inch
	≥ 90 kg	22 gauge, 1.5 inch
Gluteal	N/A	22 gauge, 1.5 inch

# Invega Sustenna

## Preparation

2. Shake the syringe vigorously for at least 10 seconds, until the suspension is uniform.

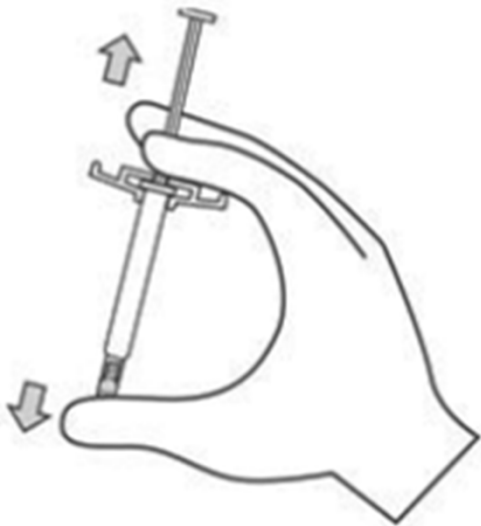

3. While holding the syringe upright, twist the rubber cap clockwise to remove.



# Invega Sustenna

## Preparation

4. Peel the safety needle pouch halfway open. Holding the needle sheath by the plastic peel pouch, attach the syringe to the needle by twisting clockwise.

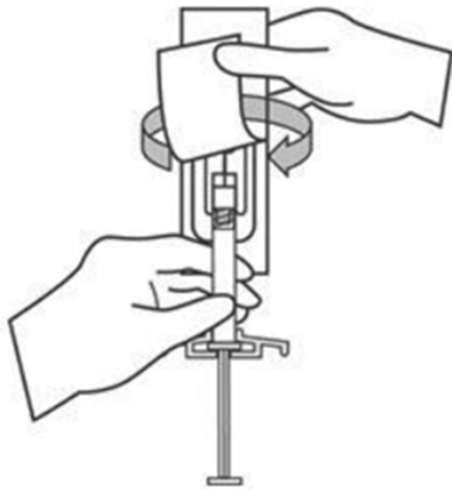

5. Holding the syringe upright, remove the needle sheath with a straight pull. Remove excess air from the syringe by advancing the plunger rod carefully. Do not twist the needle sheath.

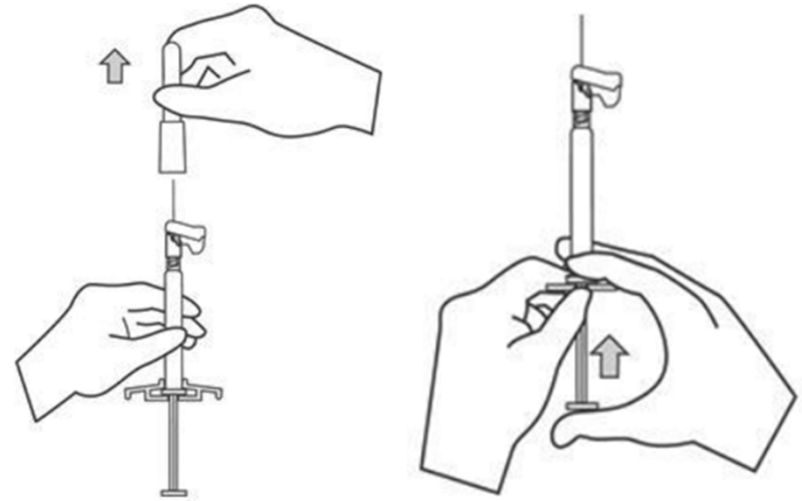

# Invega Sustenna

## Administration

1. Inject the entire contents into the designated muscle slowly.
  - a. Invega Sustenna may be administered in either the deltoid or gluteal muscle
2. After administration, engage the needle protection system until a click is heard.
3. Discard of the used syringe and needle appropriately.

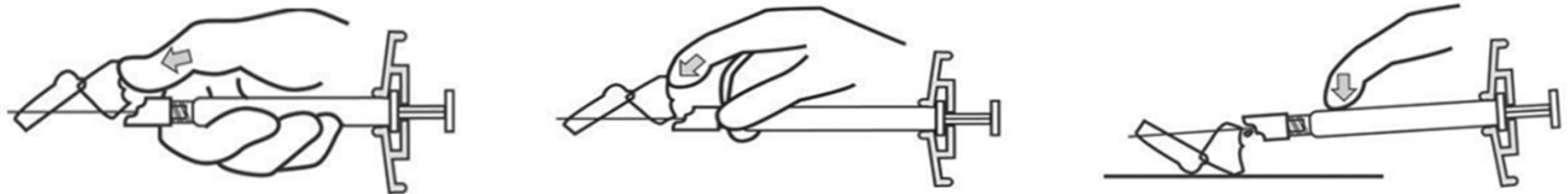

# Invega Trinza

## Package Contents

- One Invega Trinza prefilled syringe
- One 22 gauge, 1 inch safety needle (pink hub)
- One 22 gauge, 1.5 inch safety needle (yellow hub)

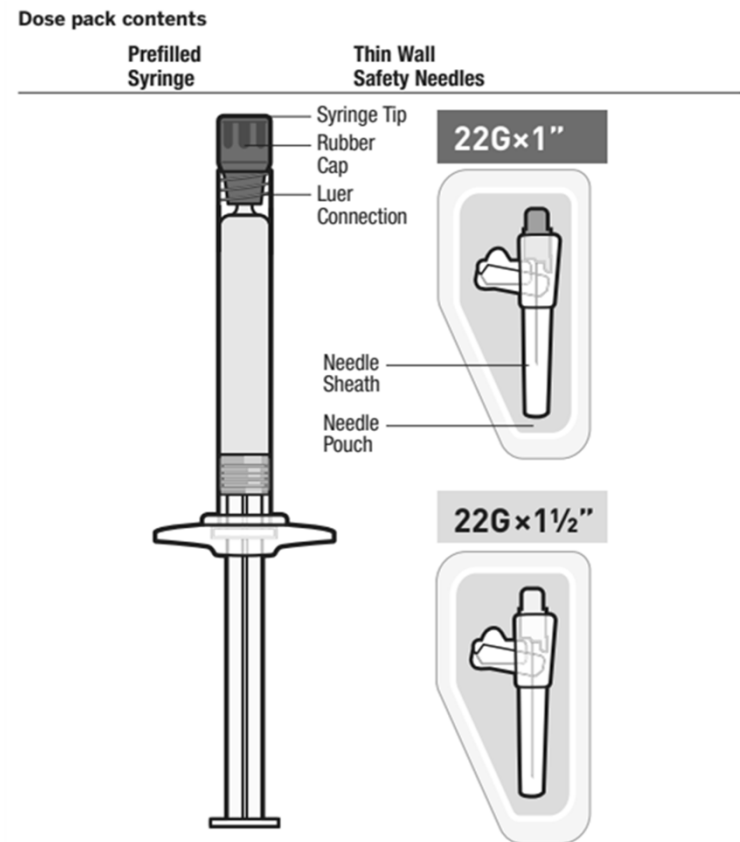

# Invega Trinza

## Preparation

1. Select the appropriate needle size by injection site and patient weight

<b>Injection Site</b>	<b>Patient Weight</b>	<b>Needle Size</b>
Deltoid	< 90 kg	22 gauge, 1 inch
	≥ 90 kg	22 gauge, 1.5 inch
Gluteal	N/A	22 gauge, 1.5 inch



# Invega Trinza

## Preparation

2. Shake the syringe vigorously for at least 15 seconds.

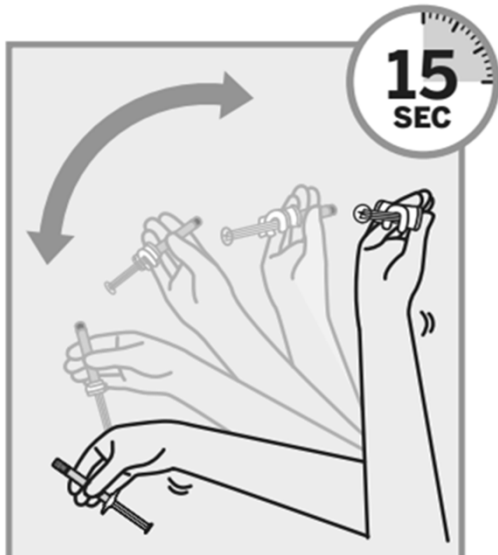

If not administered within 5 minutes, shake for another 15 seconds prior to administration.

3. Check the suspension in the viewing window. It should appear uniform and milky white in color.



It is normal to see small air bubbles.

# Invega Trinza

## Preparation

4. Peel open the needle pouch half way and remove the rubber syringe cap by twisting clockwise.

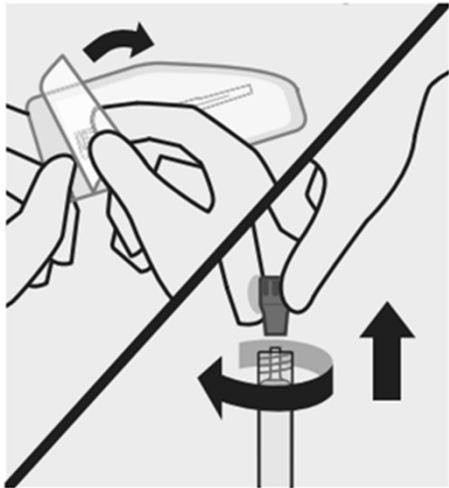

5. Holding the needle sheath through the pouch, attach the needle to the syringe by twisting clockwise until secure.



# Invega Trinza

## Preparation

6. Holding the syringe upright, remove the needle sheath with a straight pull.

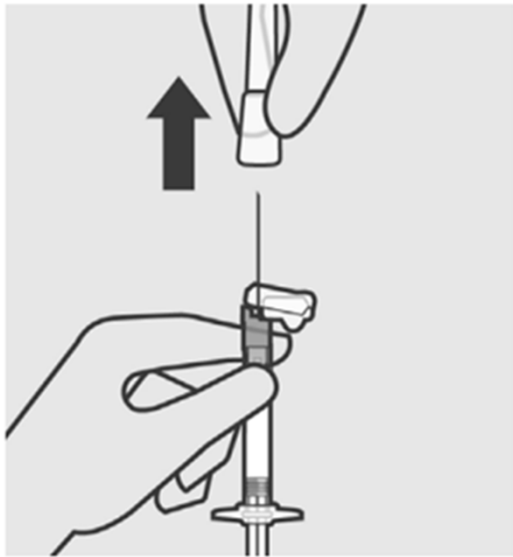

7. Remove excess air from the syringe by advancing the plunger rod carefully.

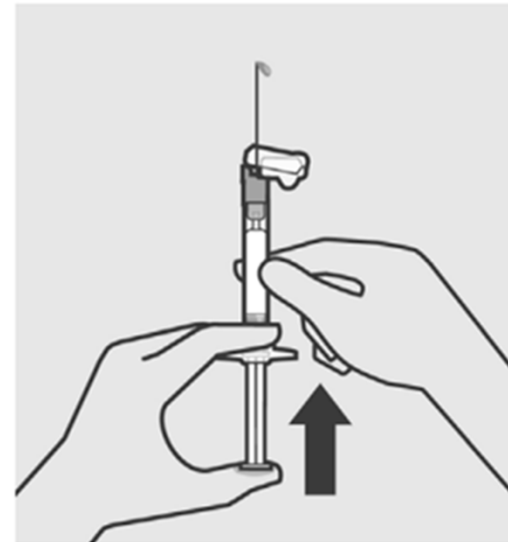

# Invega Trinza

## Administration

1. Slowly inject the entire syringe contents in the deltoid or gluteal muscle.

2. After administration, engage the needle protection system until a click is heard. Discard appropriately.

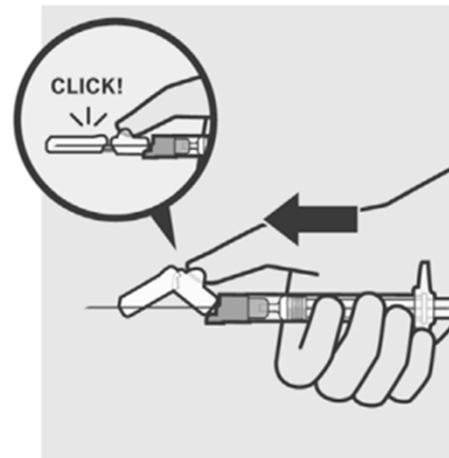
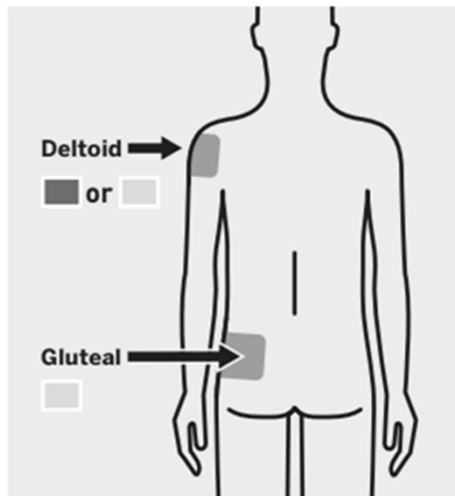

# Invega Hafyera

## Package Contents

- One Invega Hafyera prefilled syringe
- One 20 gauge, 1.5 inch safety needle

Dose pack contents  
Prefilled Syringe

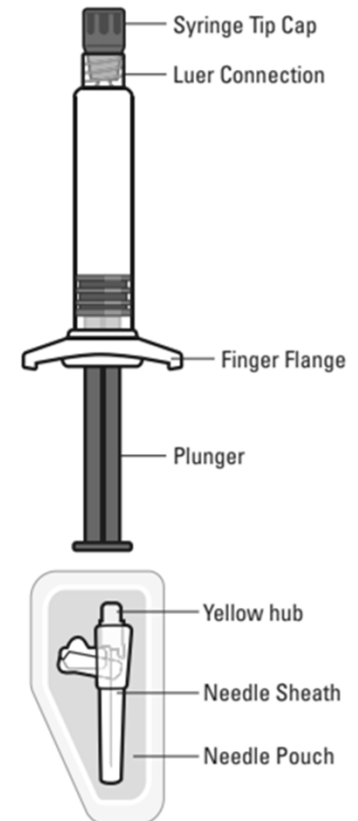

Thin Wall Safety Needle



20G x 1½"

Only use the needle  
included in this kit

# Invega Hafyera

## Preparation

1. Shake the syringe VERY FAST for at least 15 seconds. Rest briefly, then shake for another 15 seconds.

2. Check the suspension for solid product. If not properly suspended, repeat step 1.

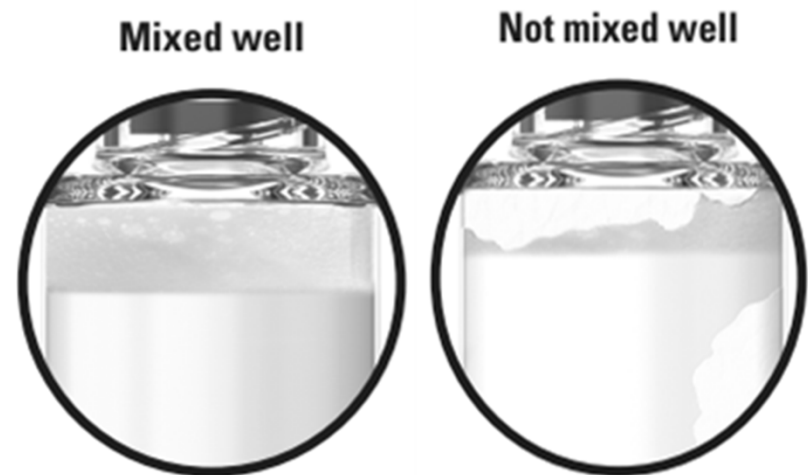

If not administered within 5 minutes, shake for another 30 seconds prior to administration.

# Invega Hafyera

## Preparation

3. Remove the rubber syringe tip cap with a twist. Attach the provided needle by twisting clockwise until secure.

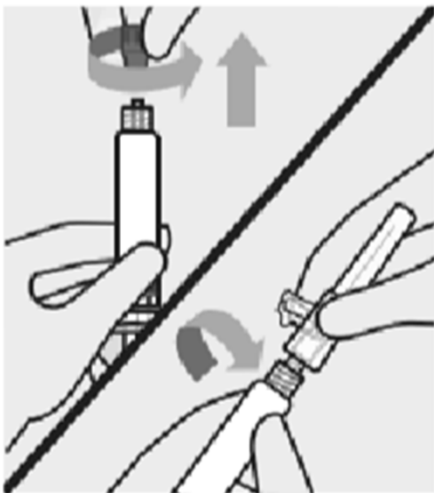

4. While holding the syringe upright, gently pull back the plunger to clear the syringe tip of any solid product.

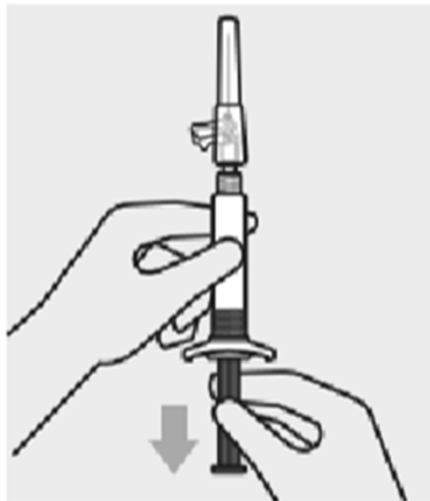

5. Remove excess air by advancing the plunger until a drop of liquid comes out of the needle tip.

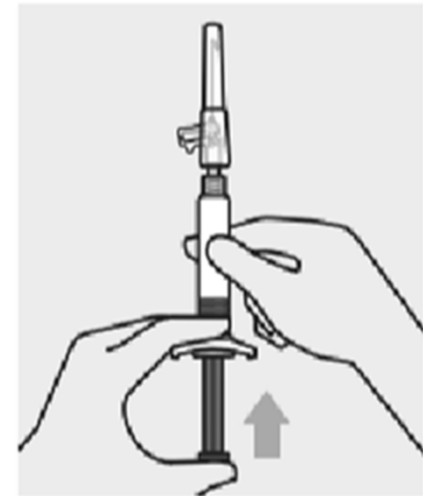

# Invega Hafyera

## Administration

1. Remove the needle sheath from the needle with a pull. Do not twist.
2. Slowly inject the entire contents of the syringe into the gluteal muscle.
  - a. The gluteal muscle is the ONLY site of administration for Invega Hafyera
  - b. To confirm complete administration, use slow, firm, constant pressure on the plunger for about 30 seconds. The feel of some resistance is normal.

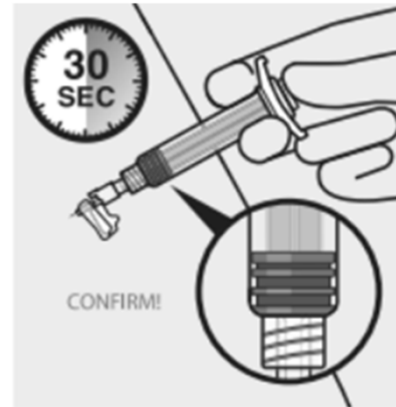
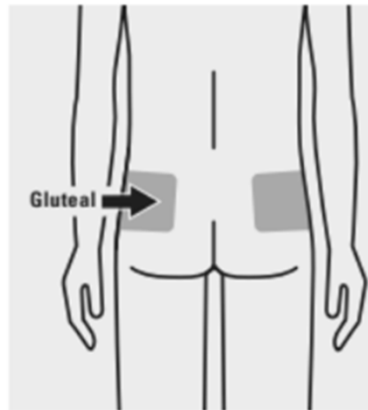

1. Secure the needle safety device with a 'click' and properly dispose.



# Risperdal Consta

## Package Contents

- One vial adapter
- One prefilled syringe with diluent
- One Risperdal Consta vial for reconstitution
- One 21 gauge, 1 inch safety needle
- One 20 gauge, 2 inch safety needle

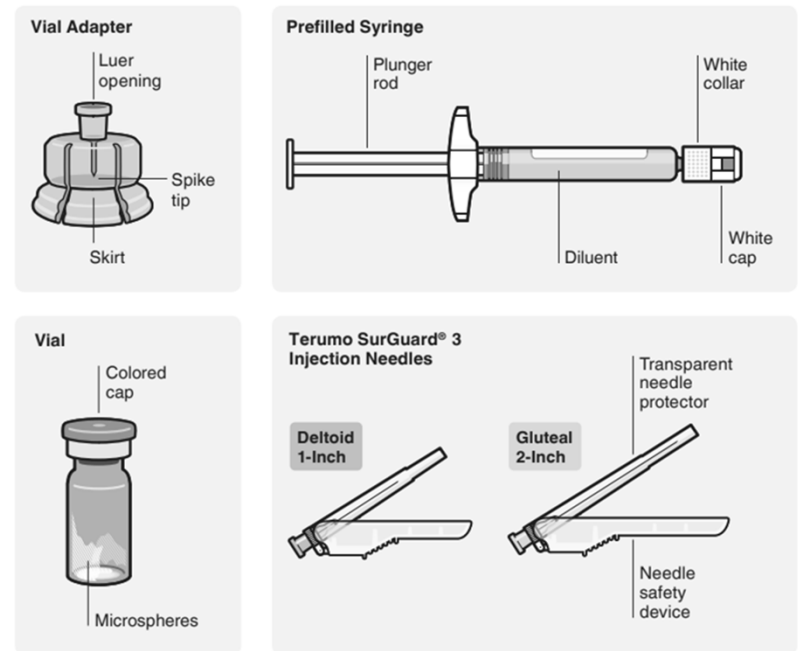

# Risperdal Consta

## Preparation

1. Remove Risperdal Consta pack from the refrigerator and allow to sit at room temperature for a least 30 minutes before reconstituting.



2. Remove the cap from the vial and wipe the top of the stopper with an alcohol swab.

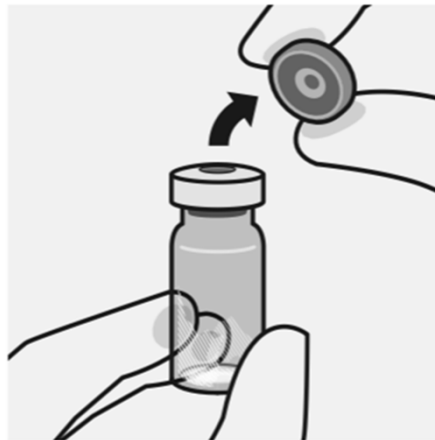

3. Open the vial adapter packaging by peeling off the paper backing. Do not remove the vial adapter from the blister.

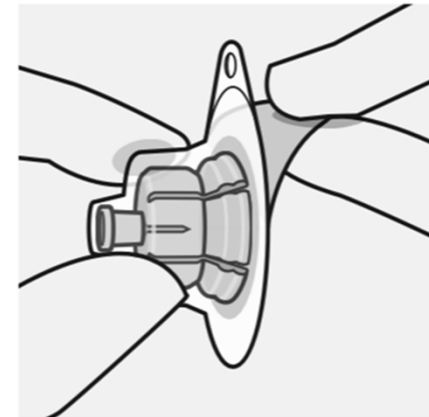

# Risperdal Consta

## Preparation

4. With the vial placed on a hand surface, connect the vial adapter the the vial by pushing the spike tip through the rubber stopper. After the adapter is secure the blister can be removed.



5. While holding the syringe by the white collar at the tip, snap off the white syringe cap. Do not twist or cut off.

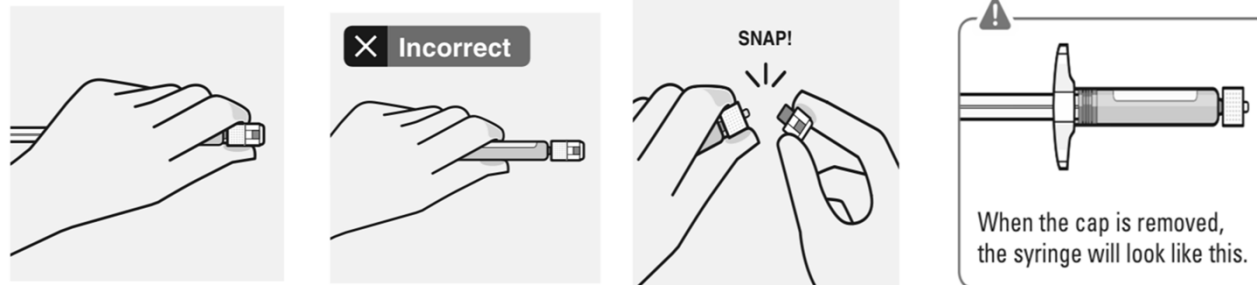

# Risperdal Consta

## Preparation

6. Connect the syringe to the vial adapter by holding the syringe by the white collar and twisting clockwise until secure.

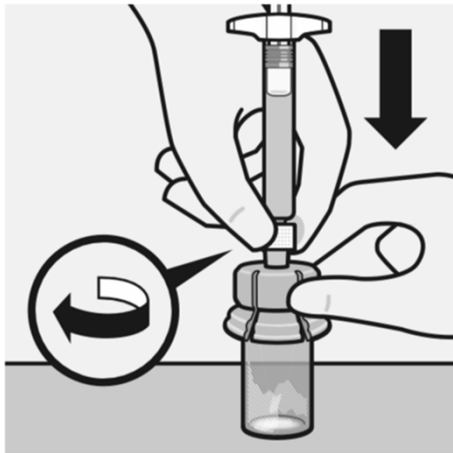

7. Inject the entire amount of diluent from the syringe into the vial. Keep holding the plunger rod down with a thumb.

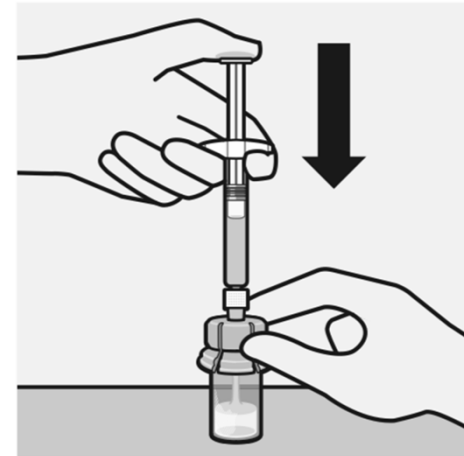

Do not over-tighten.

# Risperdal Consta

## Preparation

8. While continuing to hold down the plunger rod, shake vigorously for at least 10 seconds to suspend the microspheres.



9. Invert the vial and slowly pull the plunger rod to withdraw the entire vial contents into the syringe.

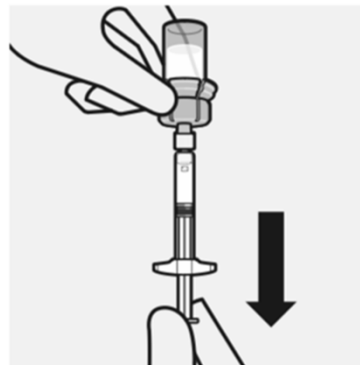

10. Remove the syringe from the vial adapter while holding it by the white collar of the syringe.

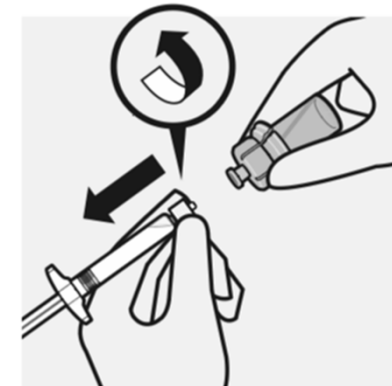

# Risperdal Consta

## Administration

1. Select and attach the appropriate needle by injection site. Holding the syringe by the white collar, twist clockwise onto the needle until secure.
2. Just before injection, shake the syringe vigorously once again to resuspend any microspheres that may have settled.
3. Remove the needle cap and expel air bubbles by pushing the plunger rod upwards.

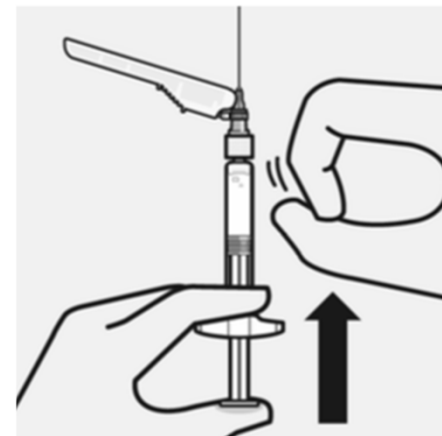
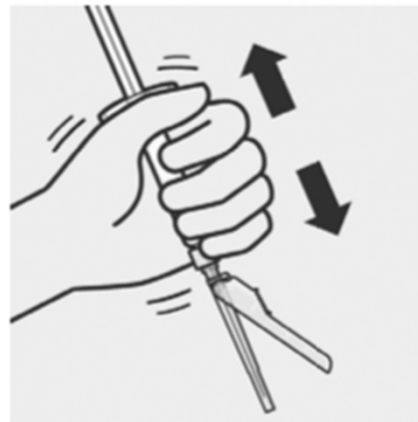
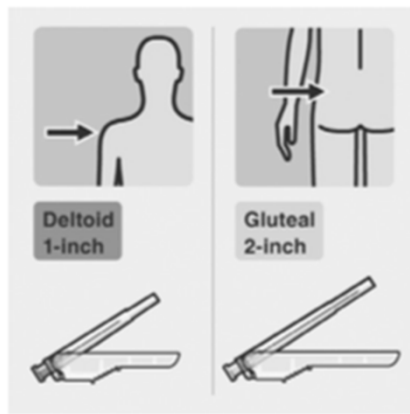

# Risperdal Consta

## Administration

4. Inject the entire contents of the syringe intramuscularly. Risperdal Consta may be administered in the gluteal or deltoid muscle.

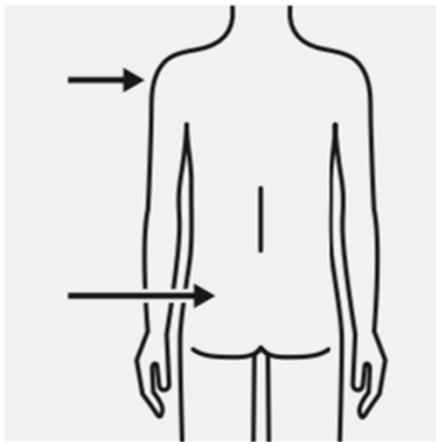

5. Secure the needle in the safety device by pressing it down on a hard, flat surface and dispose appropriately.

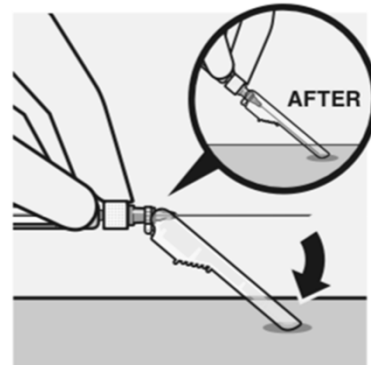

# Uzedy

## Package Contents

- One Uzedy single-dose, prefilled glass syringe
- One 21 gauge,  $\frac{5}{8}$  inch needle

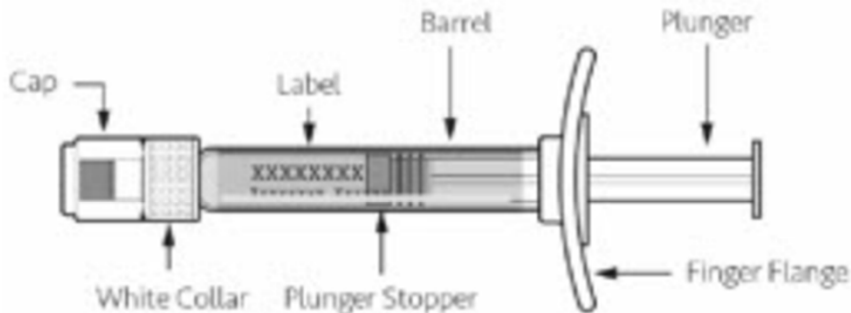

**Prefilled Syringe**

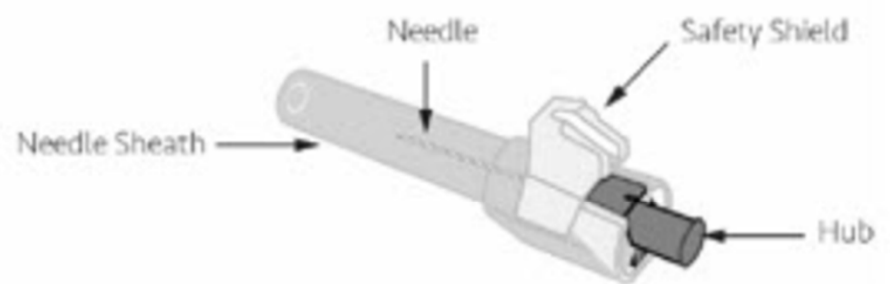

**Safety Needle**



# Uzedy

## Preparation

1. Remove Uzedy from the refrigerator and allow to sit at room temperature for at least 30 minutes.



2. Check that the suspension is opaque, white to off-white in color, and free from any particulate matter. Check that the appropriate needle is provided.

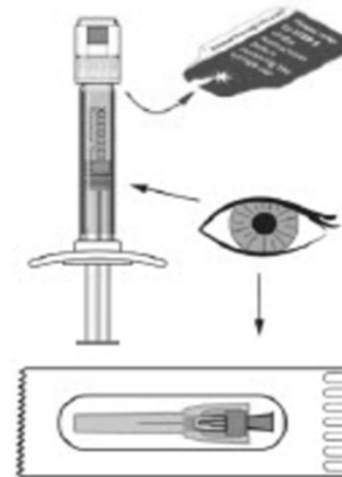

# Uzedy

## Preparation

3. While holding the syringe firmly by the white collar, flick the syringe forcefully downward in a whipping motion. Do this 3 times, until the air bubble is at the cap of the syringe.

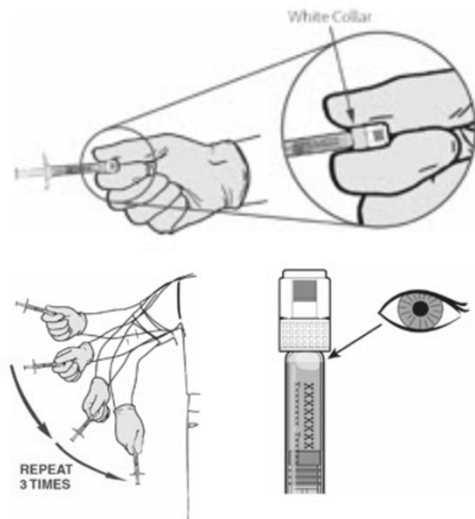

4. Holding the syringe by the white collar, snap off the cap. Attach the provided needle with a twist until it is secure. Ensure that the hub has not been damaged.

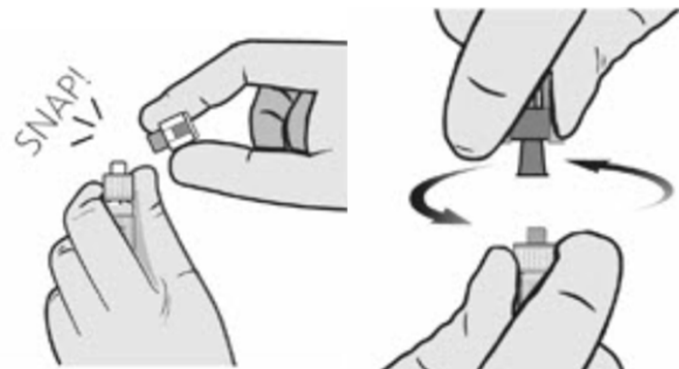

# Uzedy

## Administration

1. Choose the injection site.  
Uzedy may be administered **SUBCUTANEOUSLY** in the abdomen or back of the upper arm.
  - a. Choose a site with adequate subcutaneous tissue that is free of skin conditions.
  - b. Do not inject into an area in which the skin is irritated, reddened, bruised, or scarred.

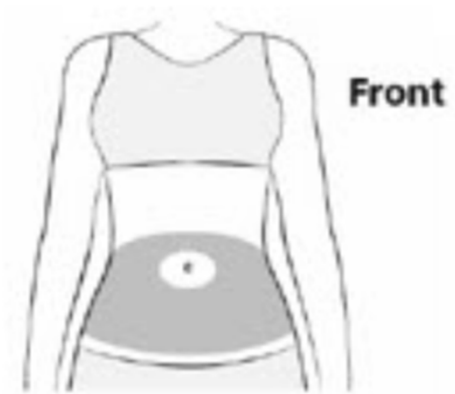

# Uzedy

## Administration

2. Remove the needle sheath with a pull. **Do not** expel the air bubble.

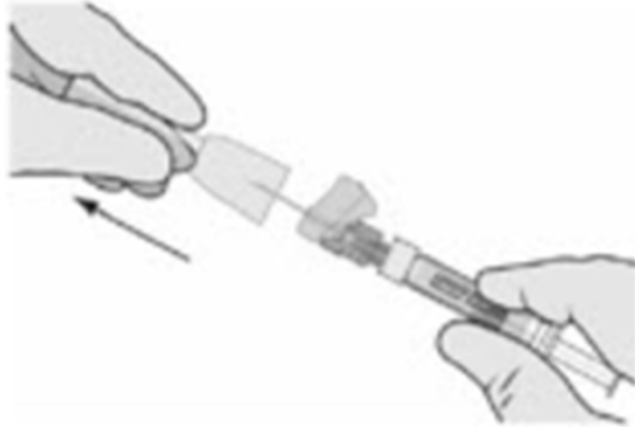

3. Pinch at least 1 inch of the area of skin.

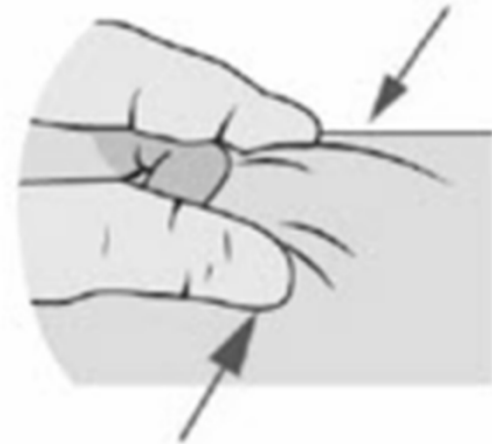

# Uzedy

## Administration

4. Insert the needle into the subcutaneous tissue at a 45° angle.

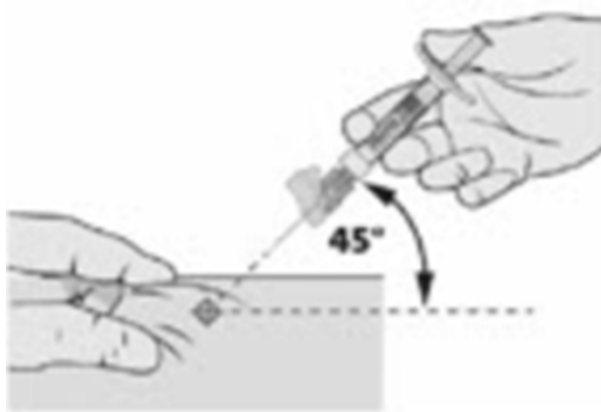

5. Release the pinched skin once the needle is inserted fully.

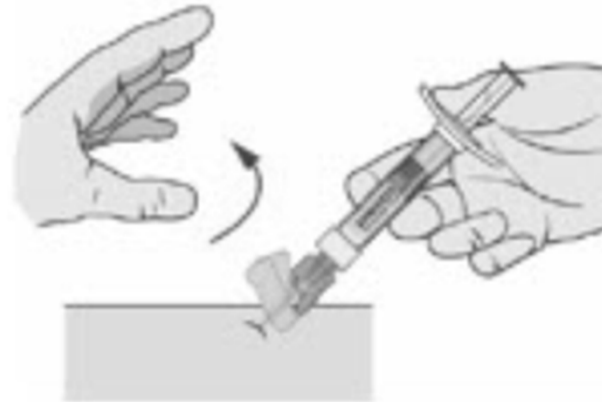

# Uzedy

## Administration

6. Inject the entire contents of the syringe with a slow, firm, and steady push.

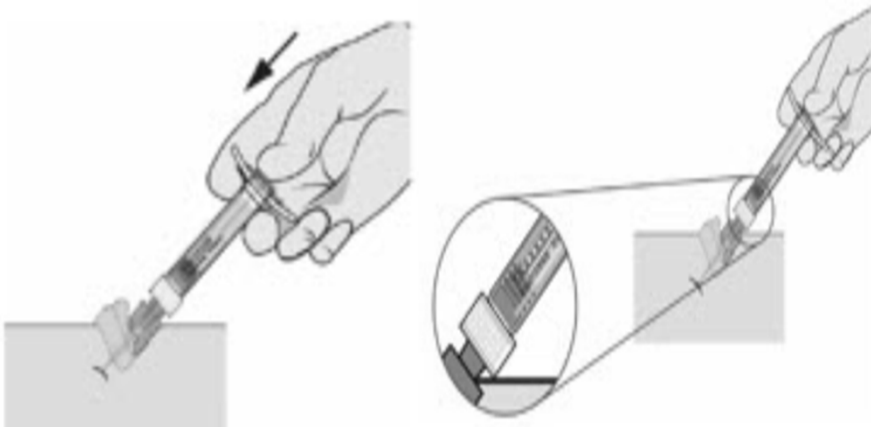

7. Two to three seconds after entire dose is delivered, remove the needle. Engage the needle safety and discard.

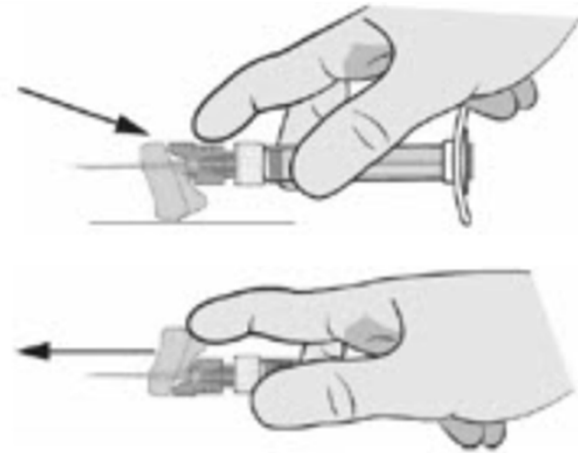

# Sublocade

## Package Contents

- One Sublocade prefilled syringe
- One safety needle

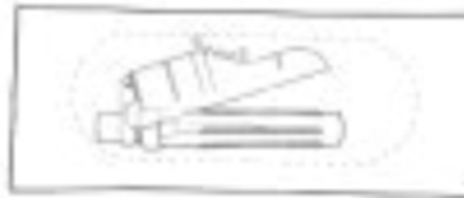

# Sublocade

## Preparation

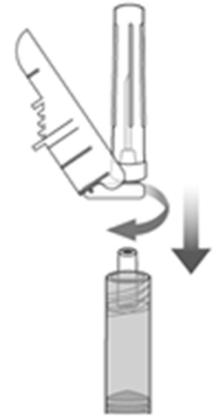

1. Remove Sublocade from refrigerator and let sit at room temperature for  $\geq 15$  minutes
  - a. Can be left at room temperature for up to 7 days\*
2. Remove from foil pouch and discard oxygen absorber pack.
3. Check the suspension for contaminants or particles. It may be colorless, yellow, or amber in color.
4. Attach safety needle

\*Will be changing to 12 weeks in future



# Sublocade

## Administration

1. Sublocade may be administered subcutaneously in the abdomen, in an area where skin is free from irritation or damage of any kind. Patient should be in a supine position.

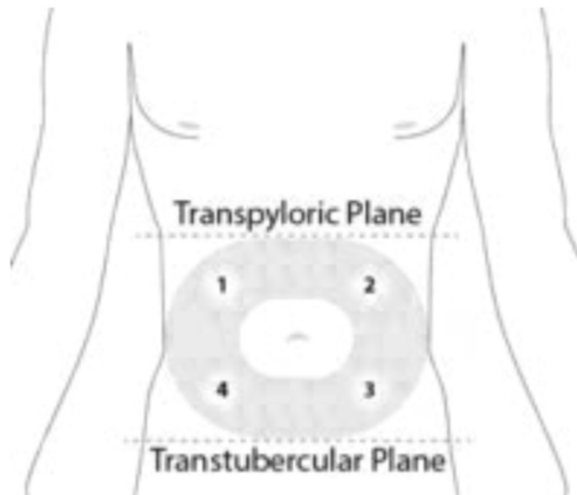

2. Hold the syringe upright and allow air bubbles to rise. Remove the needle cover and expel air by slowly depressing the plunger. Small bubbles may remain.



# Sublocade

## Administration

3. Pinch the skin around the injection site, lifting the adipose tissue from the underlying muscle.



4. Insert the needle fully into the subcutaneous tissue. Inject the full contents with a slow, steady push of the plunger.



# Sublocade

## Administration

5. Withdraw the needle using the same angle in which it was administered. Do not massage the injection site.



6. Lock the needle guard into place by pushing it against a hard surface and discard.



# Brixadi

## Package Contents

- One Brixadi prefilled safety syringe
- One syringe plunger (not attached)

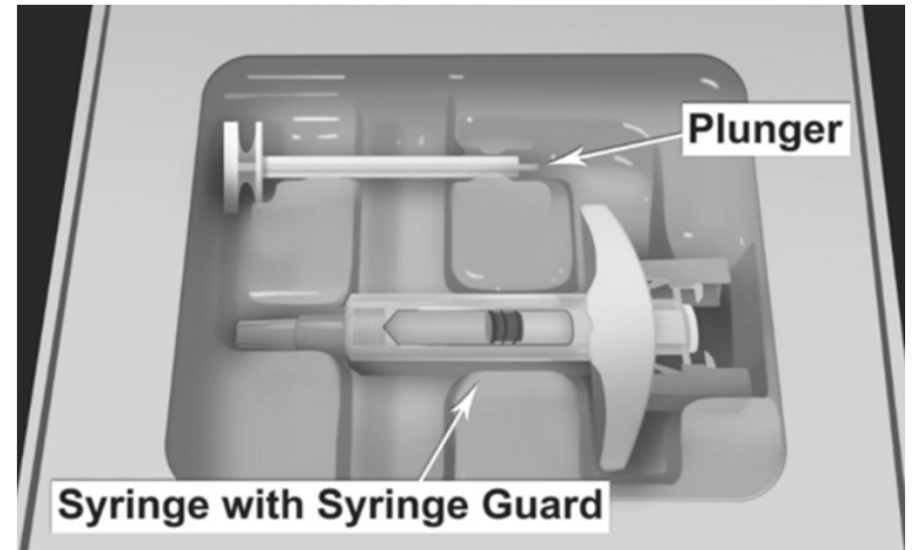

# Brixadi

## Preparation

- To assemble the safety syringe, hold the syringe guard body and insert the plunger into the body of the syringe.
- Rotate clockwise until the plunger is attached to the stoppe inside the syringe.
- Brixadi suspension should be clear and yellowish to yellow in color. A small air bubble may be visible.

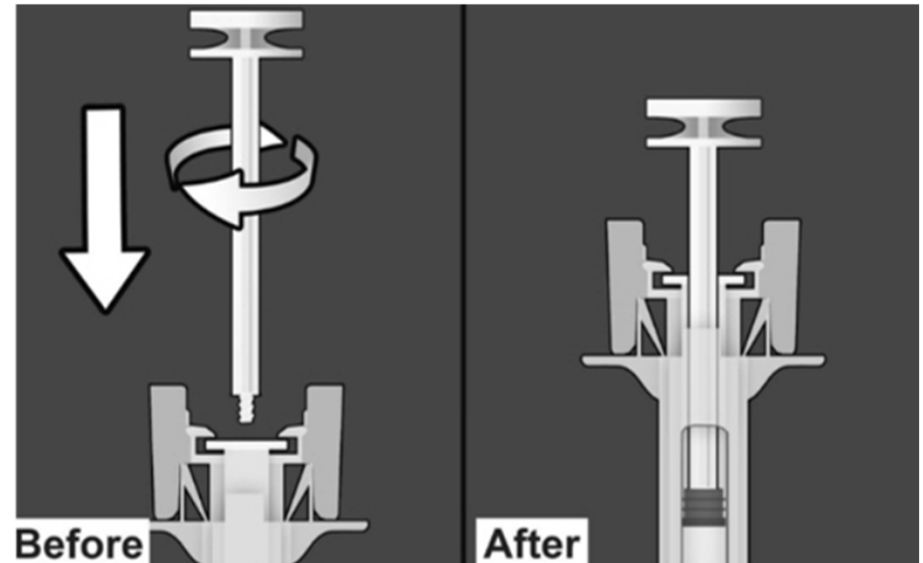

Figure 1.

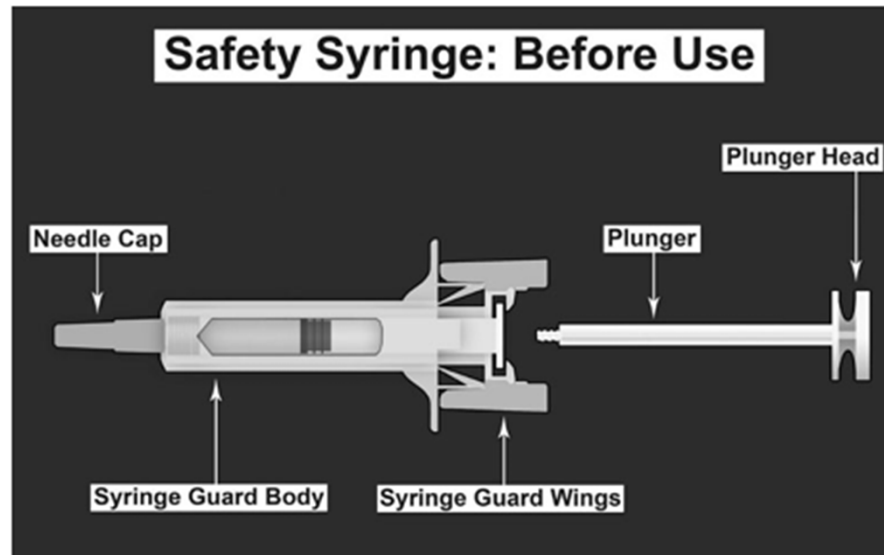
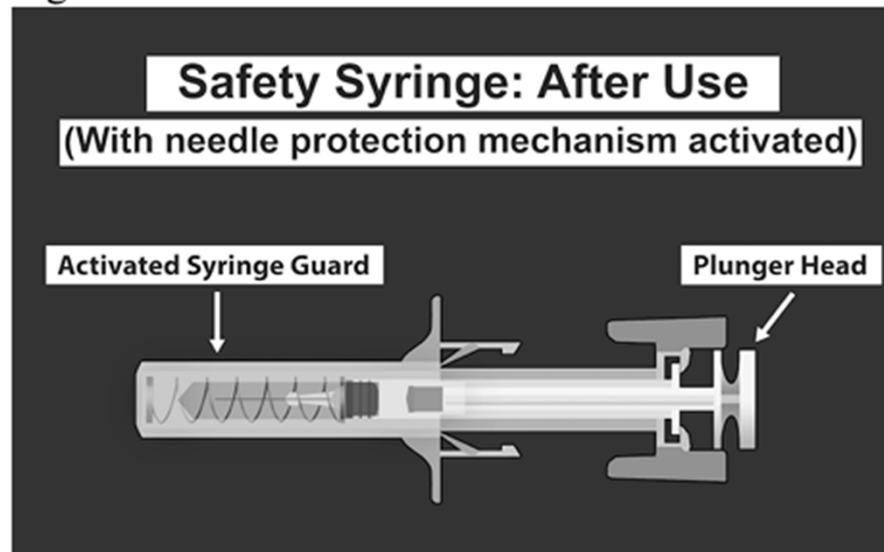

Figure 2.



# Brixadi

## Administration

1. Select an injection site. Brixadi is to be administered subcutaneously in the abdomen, thigh, upper arm, or buttock.

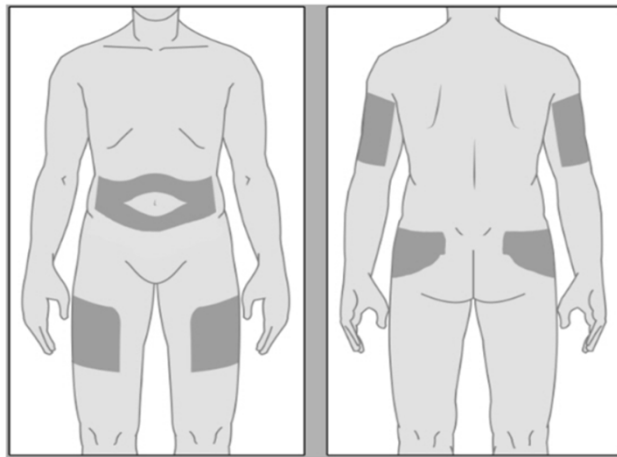

- a. Brixadi (weekly) should not be administered to the same injection site for at least 8 weeks, no injection site rotation required for Brixadi monthly.
- b. In patients not currently receiving buprenorphine treatment, for Brixadi weekly, the upper arm site should only be used after steady-state has been achieved (4 consecutive doses).

# Brixadi

## Administration

1. Remove the needle cap from the syringe by pulling straight off.



2. Pinch the skin at the injection site as shown.

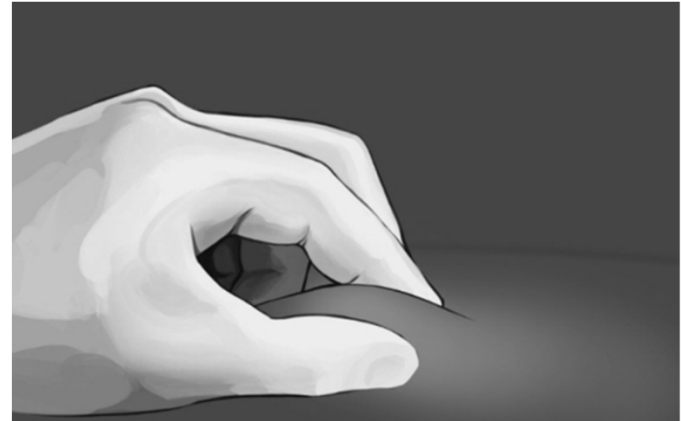



# Brixadi

## Administration

3. Continuing to pinch the skin, insert the needle at a 90° angle. Once fully inserted, release the skin.

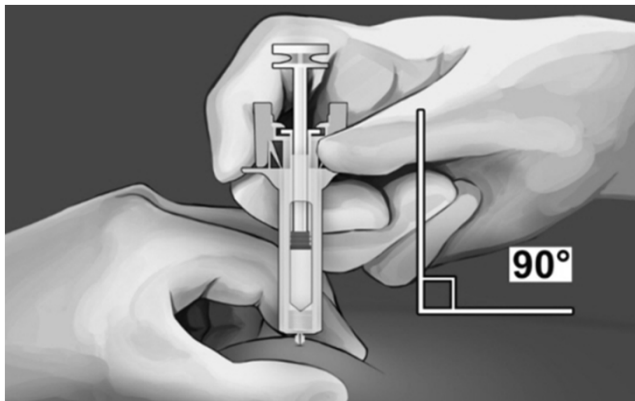

4. Inject the full contents of the syringe by slowly pressing the plunger until it latches in the safety device 'wings.' Hold the plunger down for two seconds.

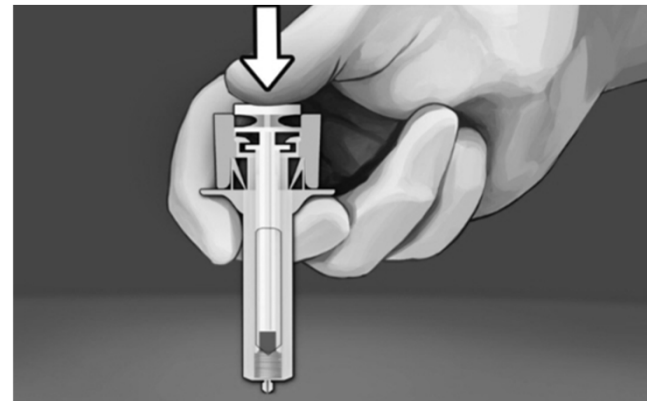

# Brixadi

## Administration

5. Keeping the plunger fully depressed while you do so, gently remove the needle from the skin.

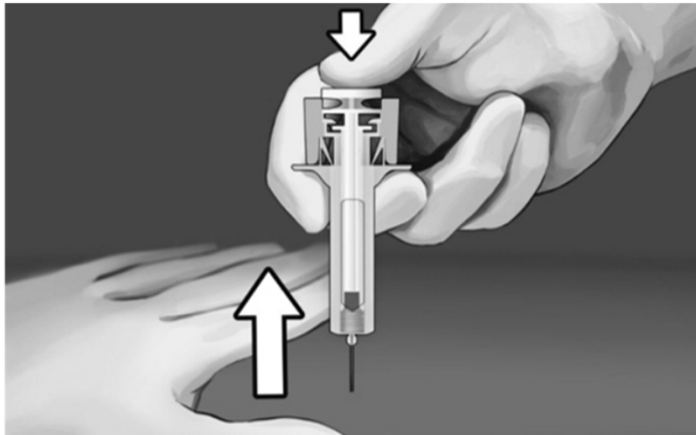

6. Remove your thumb from the plunger slowly and allow the syringe guard to automatically cover the needle. Dispose.



# Rykindo

## Package Contents

- One vial adapter
- One luer lock syringe prefilled with diluent
- One vial with Rykindo powder for suspension
- One needle with safety device

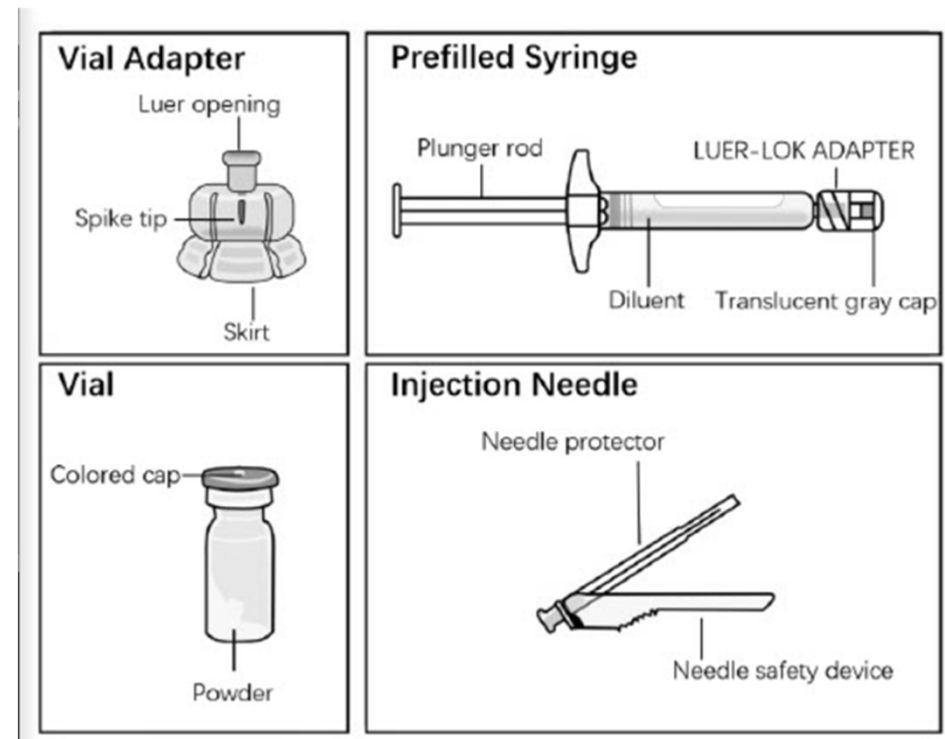

# Rykindo

## Preparation

1. Remove Rykindo from the refrigerator and allow to sit at room temperature for a least 30 minutes before reconstituting.

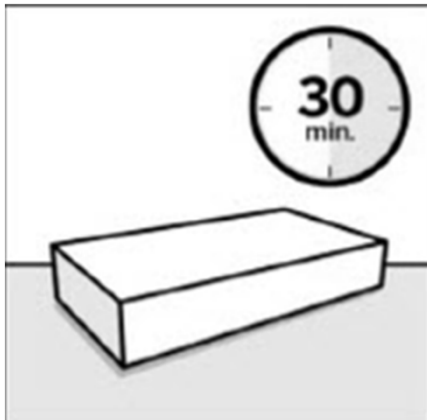

2. Remove the cap from the vial and wipe the top of the stopper with an alcohol swab.

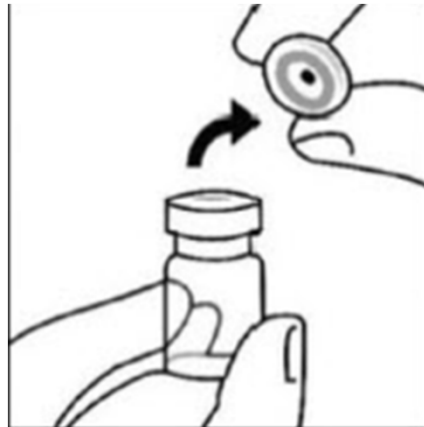

3. Open the vial adapter packaging by peeling off the paper backing. Do not remove the vial adapter from the blister.

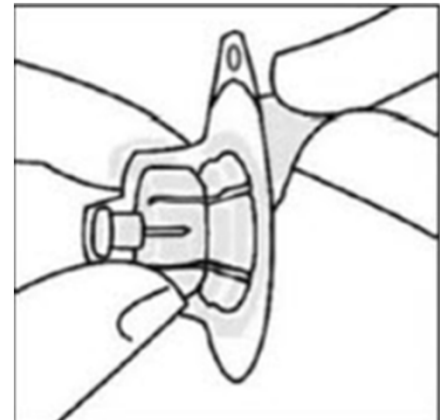

# Rykindo

## Preparation

4. With the vial placed on a hand surface, connect the vial adapter the the vial by pushing the spike tip through the rubber stopper. After the adapter is secure the blister can be removed.

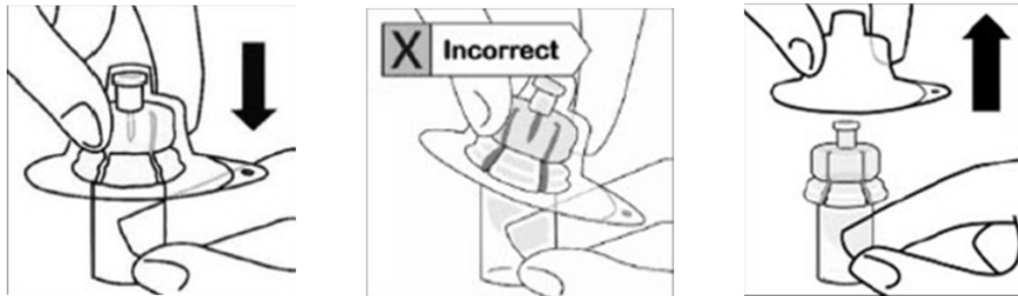

5. While holding the syringe by the luer lock tip, **twist off** the gray cap. Do not snap or cut off.

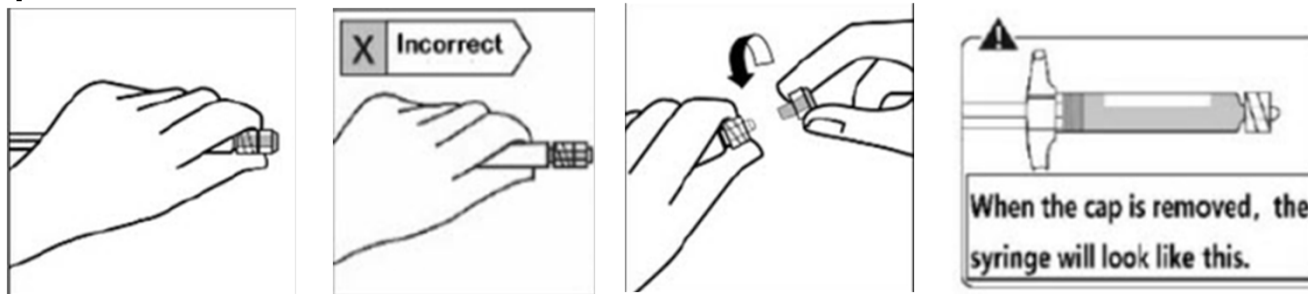

# Rykindo

## Preparation

6. Connect the syringe to the vial adapter by holding the syringe by the luer lock adapter and twisting clockwise until secure.



Do not over-tighten.

7. Inject the entire amount of diluent from the syringe into the vial. Keep holding the plunger rod down with a thumb.

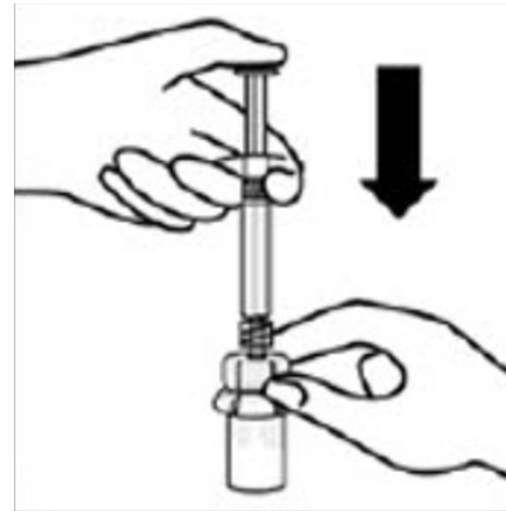

# Rykindo

## Preparation

8. While continuing to hold down the plunger rod, shake vigorously for at least 30 seconds to suspend the powder.

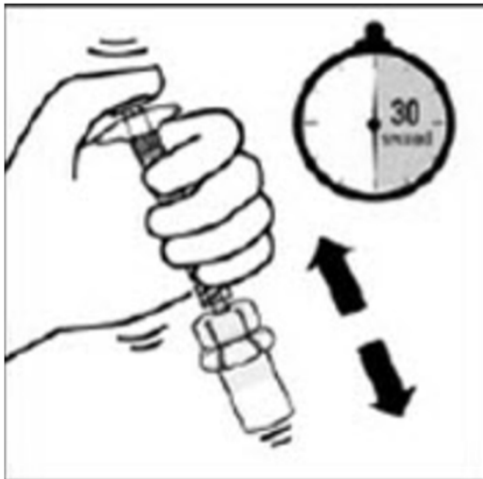

9. Invert the vial and slowly pull the plunger rod to withdraw the entire vial contents into the syringe.

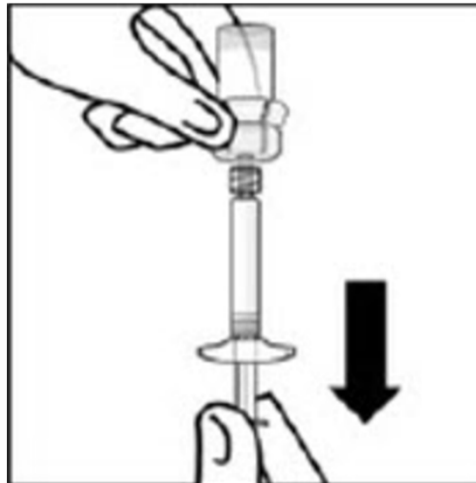

10. Remove the syringe from the vial adapter with a twist. Detach label from the vial and apply to the syringe.

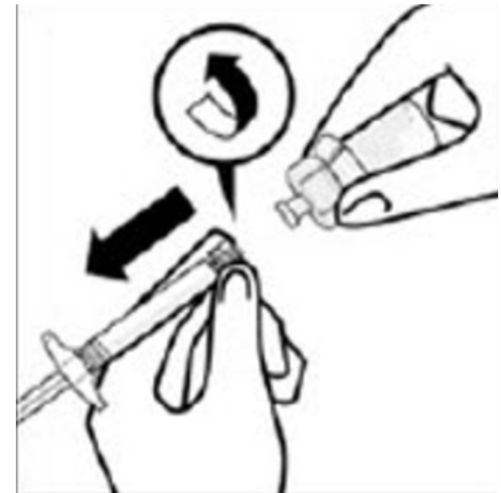

# Rykindo

## Administration

1. Holding the syringe by the luer lock adapter, attach the needle with a clockwise twist until secure.



2. Just before injection, shake the syringe vigorously for 20-30 seconds to re-disperse any powder that has settled.

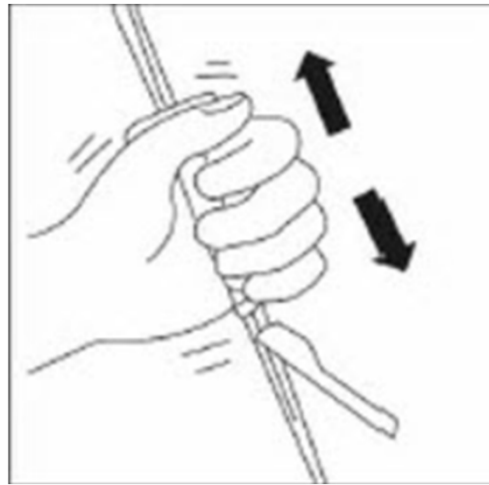

3. Remove the needle cover. Holding the syringe upright, tap out air bubbles and carefully advance the plunger rod to expel air.

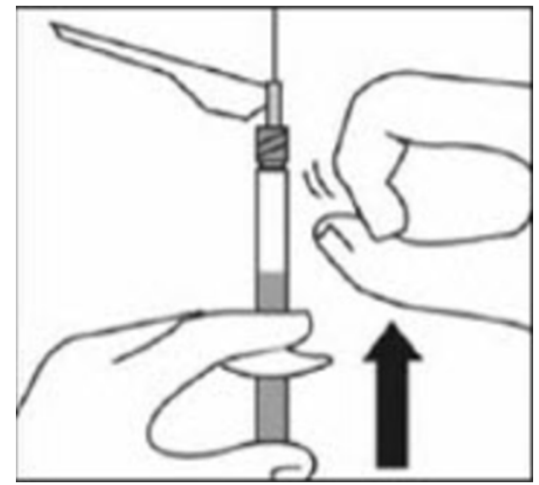



# Rykindo

## Administration

4. Inject the entire contents of the syringe intramuscularly into the gluteal muscle. The gluteal muscle is the only injection site for Rykindo.

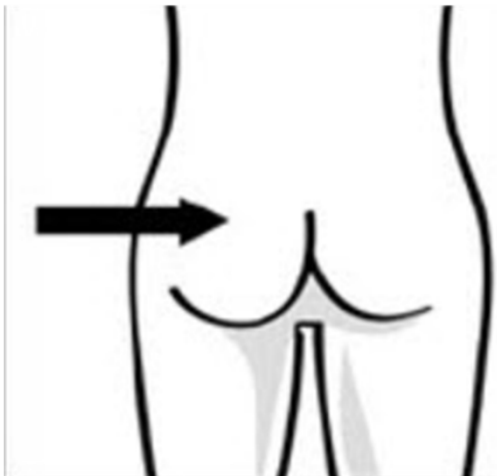

5. Secure the needle in the safety device by pressing it down on a hard, flat surface and dispose appropriately.

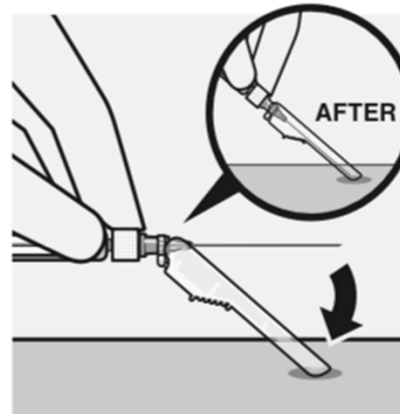

# Zyprexa Relprevv

## Package Contents

- One single dose vial of Zyprexa Relprevv powder
- One 3 mL vial of diluent
- One 3 mL syringe with preattached 19 gauge, 1.5 inch Hypodermic Needle-Pro® needle with needle protection device
- Two 19 gauge, 1.5 inch Hypodermic Needle-Pro needles with needle protection device

# Zyprexa Relprevv

## Preparation

It is recommended to wear gloves when reconstituting Zyprexa Relprevv as it can be irritating to skin

1. Determine the volume of diluent based on the vial strength

<b>Vial Strength</b>	<b>Volume of Diluent</b>
210 mg	1.3 mL
300 mg	1.8 mL
405 mg	2.3 mL

# Zyprexa Relprevv

## Preparation

2. Loosen the Zyprexa powder by lightly tapping the vial.
3. Open the pre-packaged syringe with pre-attached needle.
4. Withdraw the predetermined diluent volume into the syringe.
5. Inject the diluent into the powder vial.

# Zyprexa Relprevv

## Preparation

6. Withdraw air to equalize pressure in the vial by pulling back slightly on the syringe plunger.
7. Remove the needle from the vial while holding the vial upright to prevent any loss of material.
8. Engage the needle safety device.
9. Remove the needle and dispose.

# Zyprexa Relprevv

## Preparation

10. Tap a hard surface and tap the vial firmly and repeatedly on the surface until powder is no longer visible.

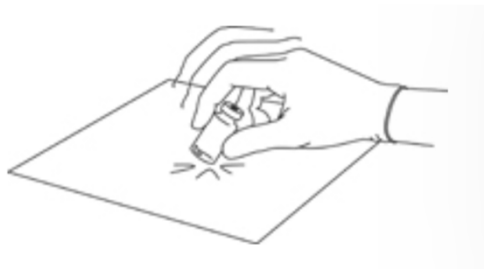

11. Visually inspect the vial for clumps. If large clumps remain, continue tapping until suspended.



12. Shake the vial vigorously until the suspension is uniform. It should be yellow and opaque.



# Zyprexa Relprevv

## Preparation

- If foam forms, let the vial sit until it dissipates.
- If the product is not administered right away, shake vigorously to resuspend prior to administration.
- Reconstituted suspension may be stored at stable room temperature for up to 24 hours.
- Once the suspension has been removed from the vial, it should be injected immediately.

# Zyprexa Relprevv

## Administration

1. Determine the volume to inject based on dose. Suspension concentration is 150 mg/mL.

<b>Dose</b>	<b>Volume to Inject</b>
150 mg	1 mL
210 mg	1.4 mL
300 mg	2 mL
405 mg	2.7 mL



# Zyprexa Relprevv

## Administration

2. Attach a new safety needle to the syringe.
3. Slowly withdraw the desired amount of product into the syringe.
4. Engage the needle safety device and remove the needle from the syringe.
5. Attach the last provided safety needle (19 gauge, 1.5 inch). For obese patient a 2 inch needle (19 gauge or larger, not included) may be used.

# Zyprexa Relprevv

## Administration

6. Insert needle into the gluteal muscle. Aspirate for several seconds to ensure no blood appears.
  - If any blood is drawn into the syringe, discard and begin with a new convenience kit.
7. Inject the full contents of the syringe intramuscularly into the gluteal muscle. Ensure to use steady, continuous pressure.

# Zyprexa Relprevv

## Administration

8. Engage the needle safety device.
9. Dispose of all kit components appropriately.

